



Midas Touch
magic embedded



Fingerprint Identification Padlock

MPL-1000

Quick Operation Guide

V1.2

Important information:

Please read this claims, before using this product

Limited warranty:

This warranty stated herein shall NOT apply, if: (1) this Product has not been used in accordance with any accompanying instructions, (2) this Product has not been used for its intended functions and environment, (3) the artificial malicious damage or personal negligence cause any defects, (4) if this Product has been opened, modified or repaired by anyone other than an authorised service centre, or if it is repaired using unauthorised spare part; Or because of an accident or other external factors causing any malfunction or defects. To use this Product in the above manner or the similar way, which will be at your own risk.

Warranty service:

1. Please make the stamp of distributor and fill in the date of purchase on the bottom of this page, as your warrantycard.
2. Offer one year limited warranty service for the product used under the normal operation and environment. (Product accessories , User manual are not in warranty range)
3. In case of improper using (such as oil or other fluids, gets wet, drops, pinched or places in the abnormal temperature and humidity) or the artificial destruction, disasters causes the damages, would be the exclusion of warranty.



Appearance and function introduction:

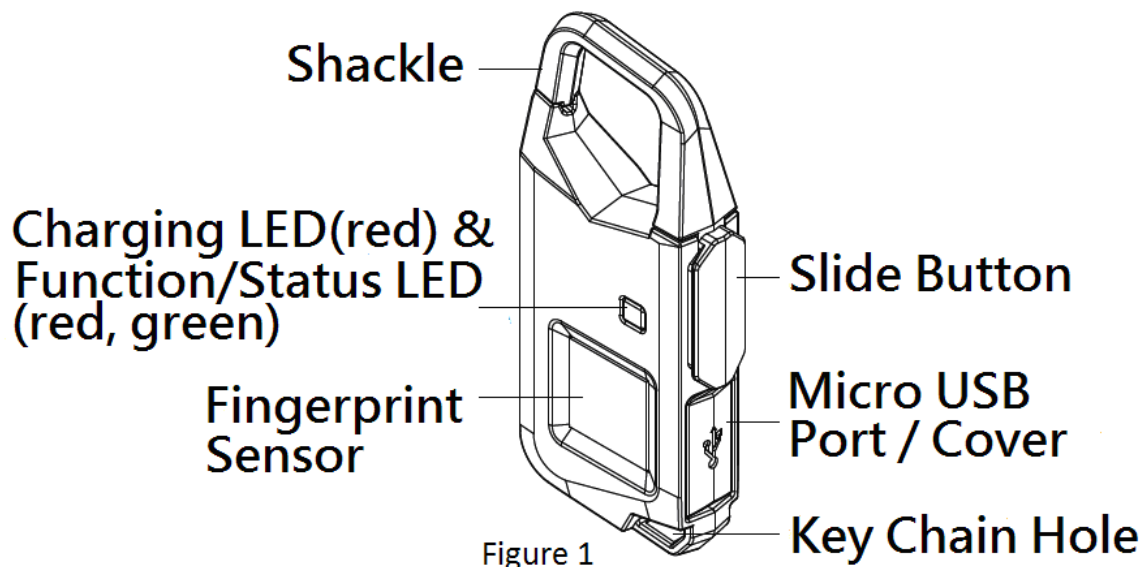

Charge the battery:

Open the USB cover, then plug in the Micro USB cable connected to the external power supply (as Figure 2) and keep the connector tightly connected. The following three cases need to charge the battery:

- (1) The first time use MPL-1000
- (2) When the battery capacity has reached the warning status of low battery (the red LED flashes 5 times which occurs in fingerprint scanning mode)
- (3) When the battery capacity is unable to start MPL-1000, charging, just like an emergency power supply for emergency unlock

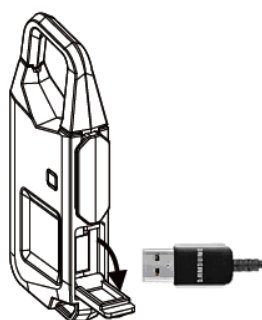

Figure 2



- Low battery status: red LED flashes 5 times
- Charging: red LED lights up
- Full charging: red LED turns off



- MPL-1000 implements the lithium-polymer battery, we recommend charging at any time in order to maintain MPL-1000 operations
- When battery capacity is low, it should be charged as soon as possible to avoid battery runs out
- In the case is not used or not charging for a long time, recommendations should be charged each month, avoiding battery runs out

Unlock:

There are two ways to unlock:

- (1) In the locked state, press the shackle of MPL-1000 once (as Figure 3) to activate MPL-1000 and then the green LED lights up and begins flashing (flashing time about 5 seconds, but in case the battery capacity reaches the low level, the red LED will light up and flashing 5 times). Now this status is fingerprint scanning mode. At this state, please press any fingers in the sensor (as Figure 4) to unlock MPL-1000, the green LED lights up and a beep sounds; then you can unlock the shackle by slide button (as Figure 5).
- (2) In fingerprint scanning mode, you must press the valid fingerprint in the sensor to unlock after you have successfully enrolled your fingerprints (the detail procedures please refer to the fingerprint enrollment) in MPL-1000, and green LED lights up and a beep sounds, then you can unlock the shackle by slide button (as Figure 5).

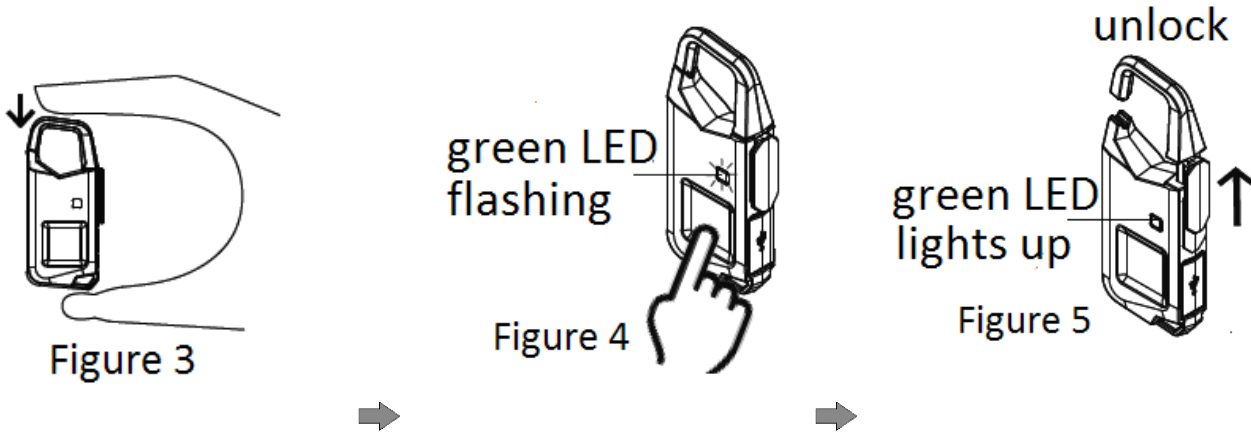

- Fingerprint scanning mode: green LED lights up and begin flashing for about 5 seconds
- Unlock: ①green LED lights up for about 5 seconds ②a beep sounds
- The first time you use MPL-1000, we recommend to immediately complete the fingerprint enrollment



- MPL-1000 will be powered off automatically if no any operations happen till green LED turns off which the fingerprint scanning mode or unlock phase
- All procedures have the time constraints, please follow the provisions in operation guide



- Unlock failure: ①red LED continuously lights up for about 2 seconds ②4 beeps sound

Lock:

In unlocked state, pressing the shackle once (as Figure 3) to lock MPL-1000 immediately, the red LED lights up for about 2 seconds and two beeps sound at the same time. And then MPL-1000 will be powered off automatically.



- Unlock: ①green LED lights up for about 5 seconds ②a beep sounds
- lock: ①red LED lights up for about 2 seconds ② two beeps sound



- All procedures have the time constraints, please follow the provisions in operation guide

Fingerprint enrollment:

- (1) Please follow the unlock procedures to enter unlock state, (green LED will continuously lights up for approximately 5 seconds, which is the important period for entering fingerprint enrollment) at the moment, continuously press and hold shackle until the red and green LED interactive flash and heard a beep sound.
- (2) Now, you can press your finger onto the fingerprint sensor to scan your fingerprints before the red, green LED interactive flashing turn off (this available time is approximately 5 seconds, as Figure 6). When your fingerprint is successfully scanned, MPL-1000 will sound a beep and green LED light up once, you can remove your finger.
- (3) Repeat step (2) until you hear a long beep, this means your fingerprint has successfully been enrolled into MPL-1000. Each finger must be done at least 7 times for the input of the fingerprint characteristics.
- (4) Each finger enrolled completely and successfully, and then the red and green flash

interactively again; repeat steps (2) ~ (3) to register other fingerprints. If you wanna

exit enrollment mode, press the shackle once directly. MPL-1000 can store up to 30 sets of fingerprints, In case the fingerprints accumulation of a total reaches 30, MPL-1000 will sound 5 beeps and the red LED lights up approximately 5 seconds, and then automatically returns to enrollment mode.

(5) In enrollment mode, when you press shackle once directly or there is no any operations within 5 seconds, MPL-1000 will sound 2 beeps and automatically power off.

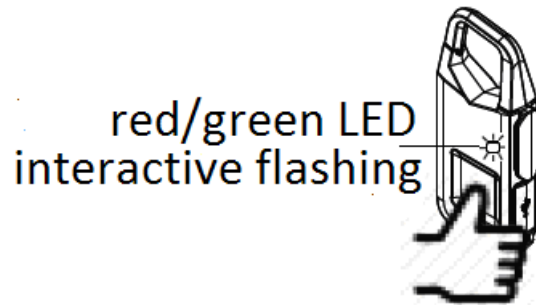

Figure 6



- Fingerprint enrollment mode: ① red and green LED alternately flashing for approximately 5 seconds ② one beep sound
- Complete each valid fingerprint enrollment must use the same fingerprint and at least 7 times for the input of the fingerprint characteristics
- Scan the fingerprint, it should be as far as possible to cover the entire sensor
- MPL-1000 stores up to 30 sets of fingerprints: ① red LED lights up for about 5 seconds ② 5 beeps sound



- In enrollment status, press shackle once directly or no any inputs within 5 seconds, MPL-1000 will sound 2 beeps and

automatically

power off.

- All procedures have the time constraints, please follow the provisions in operation guide

- MPL-1000 stores up to 30 sets of fingerprints, it can no longer

enroll



fingerprint

- Children's smaller fingers, which can not be effectively covered in fingerprint sensor to failure in recognition, it is not recommended for children to enroll fingerprints

Clear all Fingerprints:

In fingerprint enrollment phase, press the shackle and hold until the red LED lights up and then hear a long beep (this period is approximately 2 seconds), then release the shackle. Now, all fingerprints has been cleared, and then MPL-1000 will exit the enrollment phase and automatically power off.



- Fingerprint enrollment phase: ① red and green LED alternately flashing for approximately 5 seconds ② one beep sound



- All procedures have the time constraints, please follow the provisions in operation guide

Follow us

👉 Facebook B2B @ <https://www.facebook.com/midastouchinc>

👉 Instagram@ <https://www.instagram.com/midastouchinc/>

👉 Twitter@ <https://twitter.com/midastouchinc21>

👉 Website @ www.midastouchinc.com



✉ Contact Midas Touch

□ Inquiry form: Please drop your message to our inquiry form at

<https://www.midastouchinc.com/inquiry-form/>

✉ Email: Please send your inquiry to contact@midastouchinc.com