



# **Technology to IoT**

Prepared by: Marketing dept.  
Date: Q1, 2018



Midas Touch

“



- Coin → Diamond
- Orange(Sand) → Yellow(Gold)
- Round → Sky/world
- Square → Business principle
- Empty → Humble ourselves







”

# Midas Touch

“Midas Touch” is our brand. When viewed from a distance, our logo is like an ancient Chinese coin, a square encircled by a sphere, which reflects our business principle. Our logo looks like a diamond once you gaze into it. We hope that our partners will truly see our products or solutions like a valuable diamond once you use it!

*Let's shine & let's turn around the world!*

# Windows Hello Sign-In Methods Specific Messaging

Device & sign-in method	Icon (always at the left side of the text)	Approved messaging to be shown at the right side of the icon
Windows 10 device with integrated face recognition sensor		Windows Hello face sign-in
Windows 10 device with integrated fingerprint recognition sensor		Windows Hello fingerprint sign-in
Peripheral with face recognition sensor		Windows Hello face sign-in
Peripheral with fingerprint recognition sensor		Windows Hello fingerprint sign-in
Companion device with integrated biometrics sensor		Windows Hello "biometrics type" sign-in (for example Windows Hello fingerprint sign-in)
Companion device with no biometrics sensor		Windows Hello companion device sign-in

**Hello  
Touch**

# Windows Hello Finger print Sign-in

## Fast and Password-Free

with “HelloTouch”, you can login in Windows device in less than 1 second. It’s 3 times faster than a password you have to remember and type in.



# HelloTouch SPEC

## Windows 10 Option

Windows Hello

Fingerprint Compliance

## Features

- With high performance CPU, matching speed less than 1 second
- More cost effective and being flexible to be integrated to any device
- It's very easy to capture finger image, enroll and match fingerprint thru. USB interface
- ISO standard
- Low power consumption
- Small template size
- Support verification on various platform



Sensor	Capacitive Chip sensor
Scanning speed	30frame/sec
Image resolution	508dpi
Gray level	8 bits/pixel
Image ration	1:1
Interface	USB
Power	DC 5V
Dimension	25X16 mm
Operating temperature	0-70° C
Operating Humidity	0-95%
Verification speed	1:1 80msec
FRR	1/100
FAR	1/100000
ESD	15KV





# Block Diagram

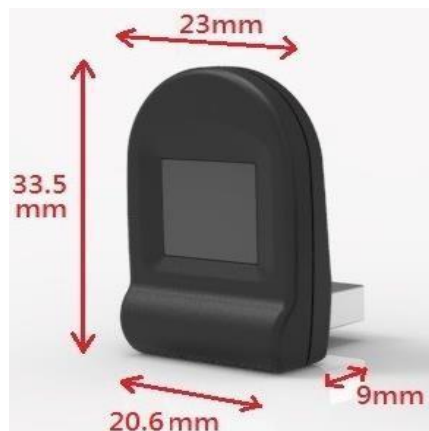

HelloTouch

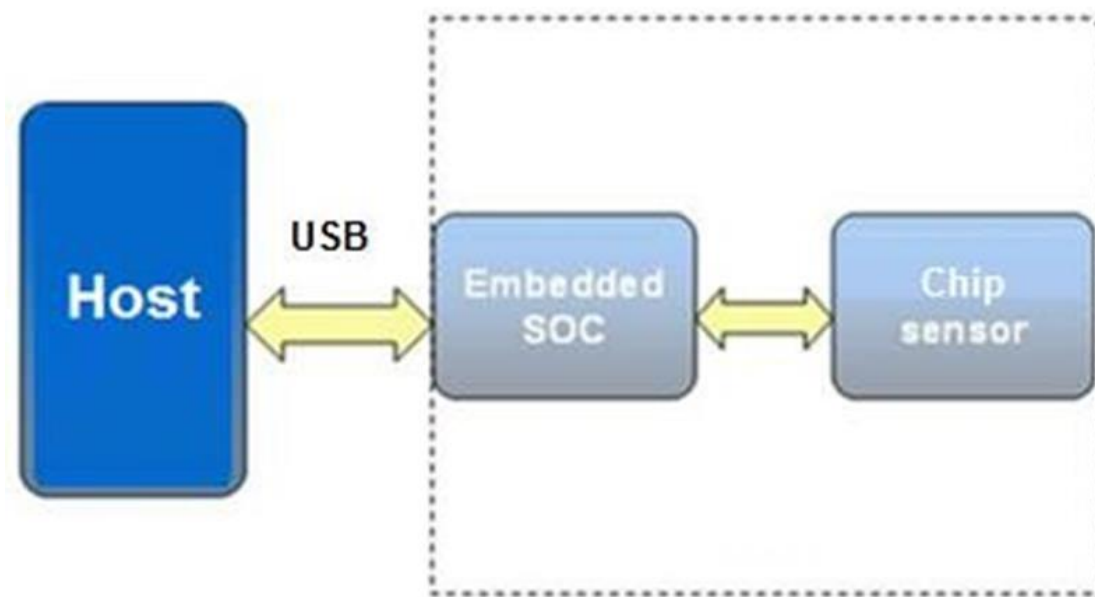



# User Flowchart I



Plug in Hello Finger

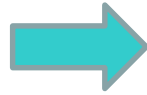

Select "accounts"

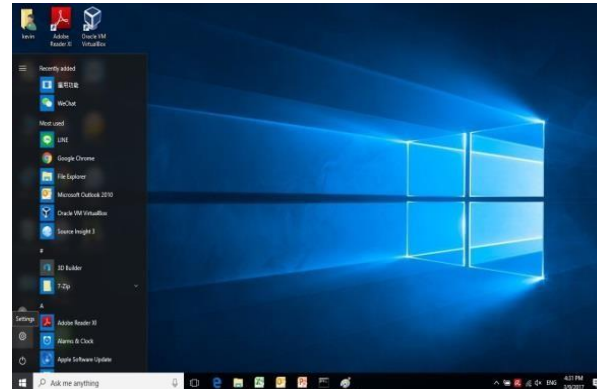
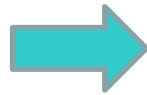

Select PC "settings"

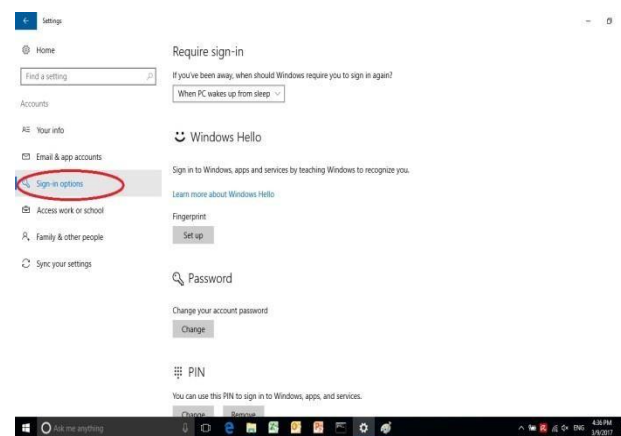

Select "sign in options"





# User Flowchart II

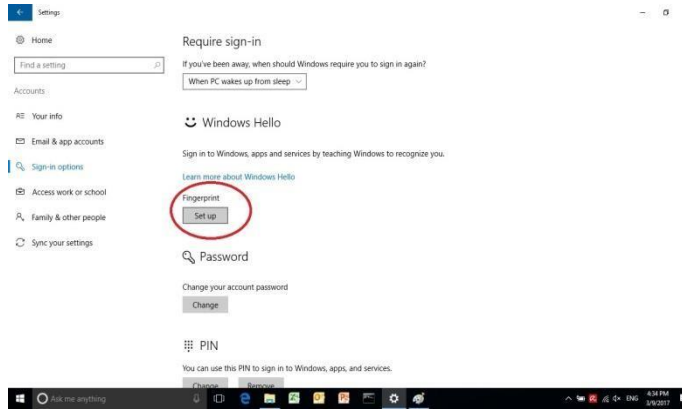

Select "fingerprint set up"

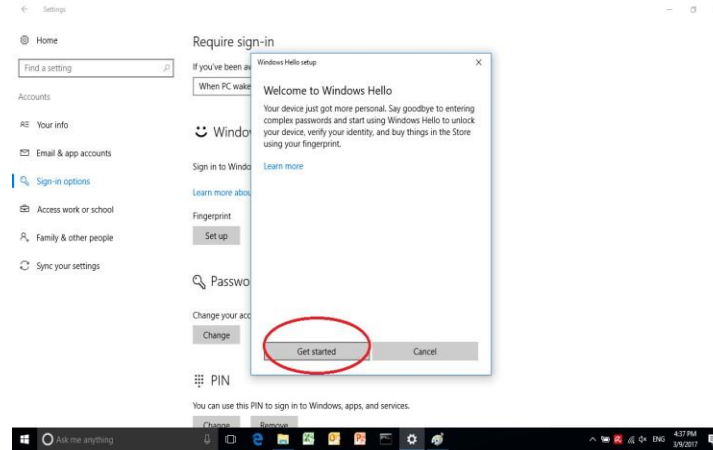
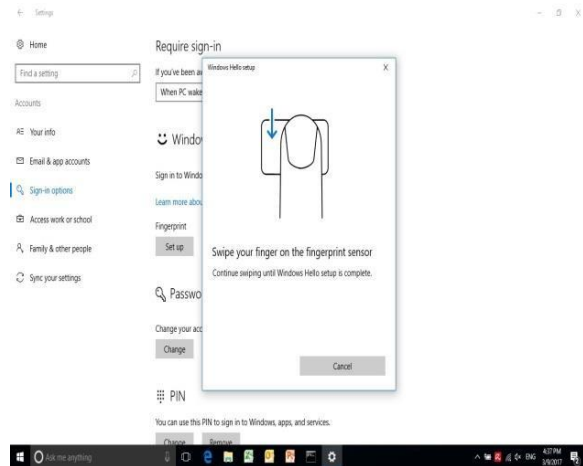

Get Started



Touch Hello Finger Sensor





# User Flowchart (III)

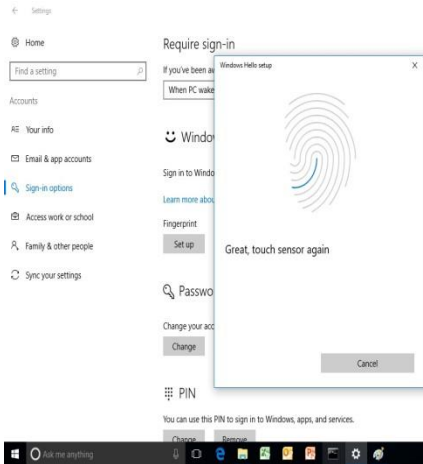

Touch sensor again



After adding in another fingerprint ,  
you are ready for windows hello.

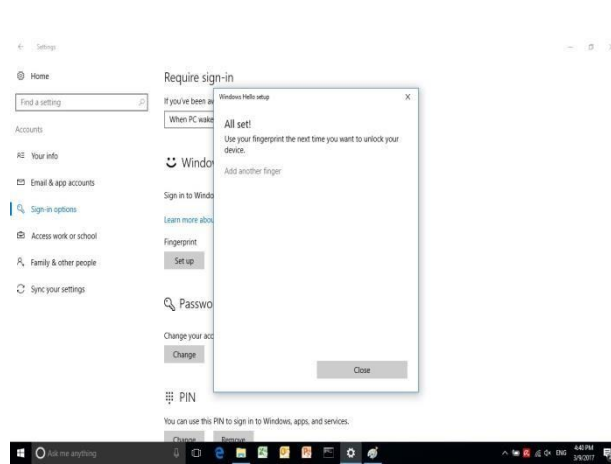

Logon finished

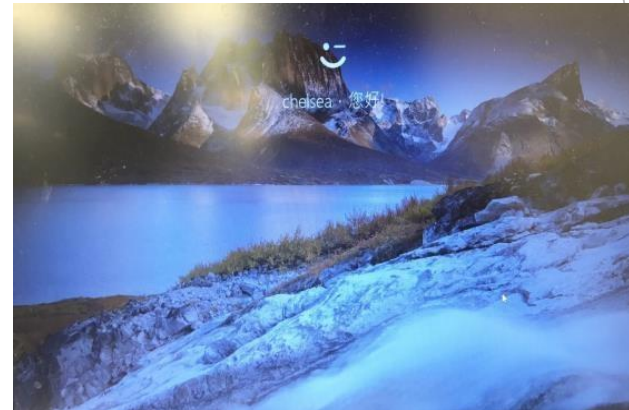



# Midas Touch

magic embedded



## Follow us



- 👉 Facebook B2B @ <https://www.facebook.com/midastouchinc>
- 👉 Twitter@ <https://twitter.com/midastouchinc21>
- 👉 Instagram@ <https://www.instagram.com/midastouchinc/>
- 👉 LinkedIn @ <http://bit.ly/midastouchinc>

### **Contact Midas Touch**

1. Facebook: Welcome to leave the message at [m.me/midastouchinc](https://m.me/midastouchinc)
2. Email: Kindly send your inquiry to [contact@midastouchinc.com](mailto:contact@midastouchinc.com)
3. Inquiry form: Please drop your message to our inquiry form at <https://www.midastouchinc.com/inquiry-form/>



# Midas Touch

magic embedded

## Head Office

17F-16, No. 1, Sec. 1, Zhongshan Rd.,  
Banqiao Dist., New Taipei City 22063, Taiwan

**T** +886-2-8953-0862

**F** +886-2-2952-8441

## RD Center

11F.-6, No.5, Sec. 3, New Taipei Blvd.,  
Xinzhuang Dist., New Taipei City 24250, Taiwan

**E** [contact@midastouchinc.com](mailto:contact@midastouchinc.com)

**W** [www.midastouchinc.com](http://www.midastouchinc.com)